

Mounting Tile

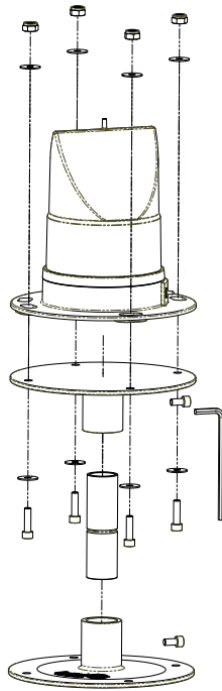

Frangible Concrete Mount

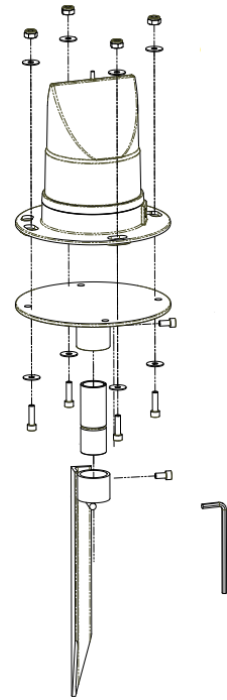

Frangible Stake Mount

#### Step 4: Install AV-70 Fixtures

The AV-70 is able to be installed on any appropriately reinforced mounting point with a 200 PCD. Alternatively, the fixture can be installed on the Avlite supplied Mounting Tile, Frangible Stake Mount or Frangible Concrete Mount.

#### Wireless Deployment:

##### Step 5: For RF enabled fixtures: Use RF Controller to test the system

Please consult the AV-70 Manual or the AvMesh™ Quick Start Guide for details on how to test the system.



#### NOTE:

For best light performance, ensure solar modules are not covered and are in clear view of the sky with no shadows

#### Wired Deployment:

##### Step 5: Connect the lights

Please consult your Lighting System Manual.

##### Step 6: Perform X Action

- For RF enabled variants, use the RF controller to test the system
- For PLC enabled variants, use PLC controller to test the system as specified by your Lighting System Manual



Head Office  
+61 (0)3 5977 6128

Avlite USA  
+1 (603) 737 1311

Avlite Asia  
+65 9119 8770



General Enquiries  
info@avlite.com

